

# BOXABL

## BABYBOX STUDIO FLOORPLAN

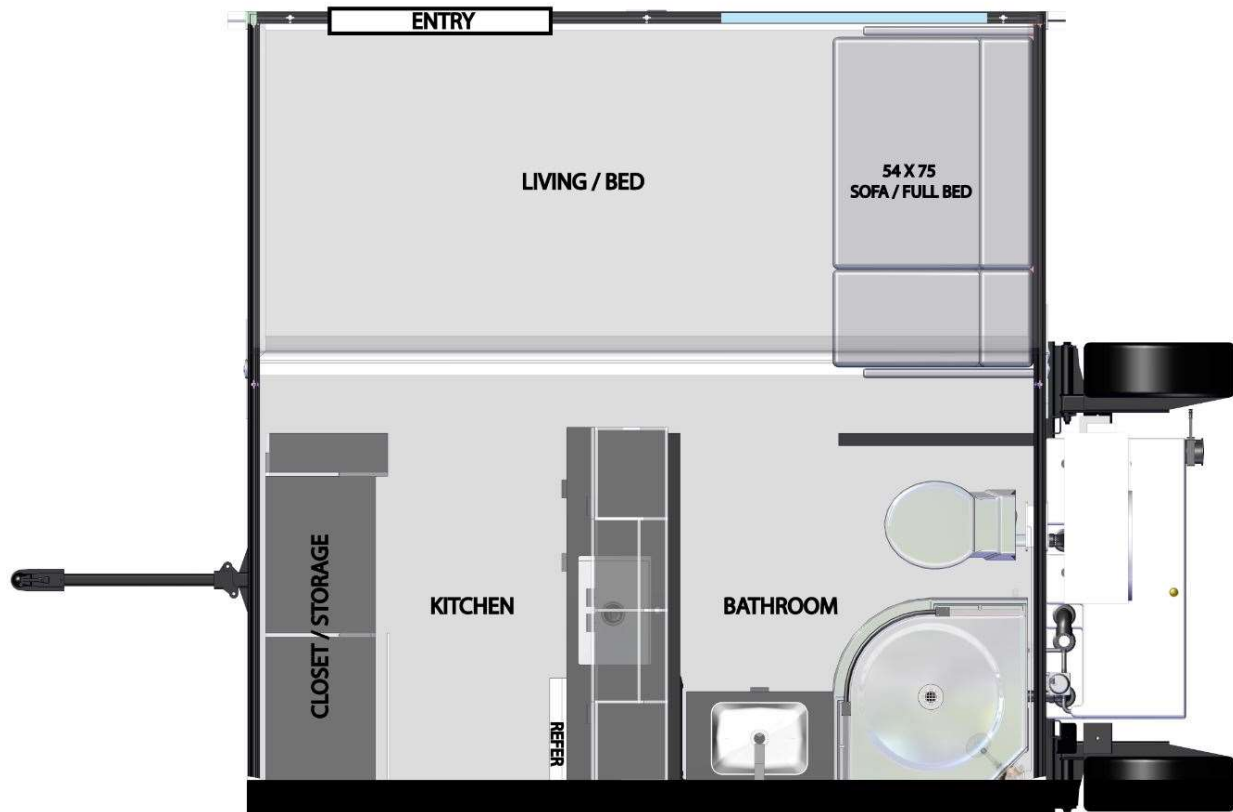

### SPECS

<b>HITCH WEIGHT</b>	<b>1000LBS</b>	<b>GVWR</b>	<b>3600LBS</b>
<b>UVW</b>	<b>2900LBS</b>	<b>CCC</b>	<b>700LBS</b>
<b>SETUP MODE</b>		<b>TRANSPORT MODE</b>	
<b>LENGTH</b>	<b>177"</b>	<b>LENGTH</b>	<b>177"</b>
<b>HEIGHT</b>	<b>111"</b>	<b>HEIGHT</b>	<b>100"</b>
<b>WIDTH</b>	<b>131"</b>	<b>WIDTH</b>	<b>78"</b>
<b>REMOVABLE EAVE</b>	<b>38" X 131"</b>		
<b>FRESH WATER</b>	<b>30 GAL</b>		
<b>BLACK WATER</b>	<b>30 GAL</b>		
<b>GREY WATER</b>	<b>30 GAL</b>		

# **FEATURES & OPTIONS**

## **KEY CONSTRUCTION AND EQUIPMENT FEATURES**

9,000 BTU Ductless A/C w/ Heat Pump (SEER2 16.7)

Powder-Coated Chassis

Independent Rear Suspension with Height Adjustment

Screwed Cabinet Construction (CARB2 Compliant Materials)

Laminate Countertops

Vinyl Flooring

Fold-out Sofa Bed with Headboard and Armrest

6 Gallon Electric Water Heater w/ 6 Gallon Per Hour Recovery

Structurally Insulated Panel Construction with Interior and Exterior Fiberglass Skins

Frame to Floor Steel Fasteners

12V On-Demand Water Pump

Hot/Cold Shower

## **STANDARD EXTERIOR FEATURES**

Rear Roof Vents

Tongue Jack

Foldable Tow Hitch

Battery Disconnect

Black Tank with Level Sensor and Waste Valve

Grey Tank with Level Sensor and Waste Valve

Fresh Water Tank with Level Sensor and Fill Port and Drain

13" Steel Wheels with Radial Tires

Plastic Fender Skirts

Exterior 110V GFCI Protected Receptacle

Exterior 30A Power Input Inlet with Cover

Dual Household Plug to Shore Power Y Adapter Cord

Exterior Utility Cabinet

Two 12V Deep-Cycle Marine Batteries

Exterior Solar Sconce Light

## **STANDARD INTERIOR FEATURES**

Dimmable LED Interior Lighting

Countertop Cooking Appliance

3.2CU FT 120VAC Refrigerator

## **STANDARD INTERIOR FEATURES CONTINUED**

Deep Drop-in Kitchen Sink

USB Receptacles in Kitchen

ABS Shower Pan and Glass Surround

Skylight Above Shower

Bathroom Vessel Sink

Towel Bar and Hooks

Marine Toilet w/ Foot Flush

12V Power Vent Fan in Bathroom

Cabinets with Drawers and Magnetic Door Catches

Bathroom Mirror

SLS (Sit-Lounge-Sleep) Sofa Bed

Closet with Sliding Doors

## **SAFETY FEATURES**

Smoke/CO2 Alarm

Fire Extinguisher

Fire Escape Window

Dead-Bolt Lock on Entry Door

# **SPECIFICATIONS DEFINITIONS**

**GVWR (Gross Vehicle Weight Rating)** – is the maximum permissible weight of the unit when fully loaded. It includes all weights, inclusive of all fluids, cargo, optional equipment and accessories. For safety and product performance do NOT exceed the GVWR.

**GCWR (Gross Combined Weight Rating)** – is the maximum permissible loaded weight of your motor home and any towed TRAILER OR TOWED VEHICLE. Actual GCWR of this vehicle may be limited by the sum of the GVWR and the installed hitch receiver maximum capacity rating: see hitch rating label for detail.

**GAWR (Gross Axle Weight Rating)** – is the maximum permissible weight, including cargo, fluids, optional equipment and accessories that can be safely supported by a combination of all axles.

**UVW (Unloaded Vehicle Weight)** – is the typical weight of the unit as manufactured at the factory. It includes all weight at the axle(s) and tongue or pin and LP gas. The UVW does not include cargo, fresh potable water, additional optional equipment or dealer installed accessories. **\*\*Estimated Average based on standard build optional equipment.**

**CCC (Cargo Carrying Capacity)** – is the amount of weight available for fresh potable water, cargo, additional optional equipment and accessories. CCC is equal to GVWR minus UVW. Available CCC should accommodate fresh potable water (8.3 lbs per gallon). Before filling the fresh water tank, empty the black and gray tanks to provide for more cargo capacity. **\*\*Estimated Average based on standard build optional equipment.**

**The load capacity of your unit is designated by weight, not by volume, so you cannot necessarily use all available space when loading your unit.**

**Actual towing capacity is dependent upon your particular loading and towing circumstances, which includes the GVWR, GAWR and GCWR as well as adequate trailer brakes. Please refer to the Operator's Manual of your vehicle for further towing information.**

**Note: Specifications are subject to change without notice.**